



MODULAR CLEANROOMS

WALL PARTITIONS, CEILING PANELS &
GRID SYSTEMS, CLEANROOM DOORS
& EQUIPMENT



ABOUT US

Avanteclad Modular Solutions LLP (AMSL) is led by a team of seasoned cleanroom experts, each enriched with over 25 years of hands-on experience. We specialize in the manufacturing of Modular Cleanroom Wall Partitions, Ceiling Panels, Grid Systems, Doors, and other allied components, enabling the seamless delivery of high-performance industrial cleanrooms for Pharmaceuticals, Medical Devices, Semiconductors, Solar PV, and Microelectronics, ensuring compliance with stringent quality and performance standards.

As a proud group company of **Avant Garde Cleanroom & Engineering Solutions Pvt. Ltd. (ACES)**, AMSL combines its manufacturing prowess with ACES's in-house expertise in design, engineering, and execution to offer comprehensive turnkey cleanroom solutions.

Expertise That Drives Excellence

At **Avanteclad Modular Solutions LLP (AMSL)**, excellence begins at the source our state-of-the-art manufacturing facility, which forms the backbone of our commitment to quality, precision, and performance.

- **Expansive Manufacturing Space** : Covering over 50,000 sq. ft. within a total infrastructure of 65,000 sq. ft., our facility is purpose-built to support the demands of high-performance cleanroom and modular solutions.
- **Strategic Location** : Conveniently based in Ahmedabad, Gujarat, AMSL benefits from direct connectivity to major ports like Mundra and Nhava Sheva, ensuring efficient logistics and on-time delivery across domestic and international markets.
- **Cutting-Edge Machinery** : Our production floor is equipped with world-class, precision-critical machinery sourced from leading global manufacturers - ensuring unmatched accuracy, consistency, and productivity at every stage of fabrication.



AVANTECLAD MODULAR CLEANROOM SOLUTIONS

We offer Progressive & Non-Progressive Cleanroom Panels and Ceiling Grid Systems for seamless installation and optimal functionality as mentioned below :

- **MODULAR PANELS FOR PHARMACEUTICAL & SOLAR PV CLEANROOMS**
 - Powder Coated (PCGI)
 - Pre-painted (PPGI)
 - Cleanroom Ceiling System
- **MODULAR PANELS FOR SEMICONDUCTOR & MICROELECTRONICS CLEANROOMS**
 - Stud & Stud-less Wall-Partitions
 - Cladding Wall Partitions
 - Grid Ceiling Systems
 - Walkable & Non-Walkable
 - Plenum Ceiling System



MODULAR PANELS FOR PHARMACEUTICAL & SOLAR PV CLEANROOMS



POWDER COATED MODULAR PANELS (PCGI)

Key Features

- Crafted from GPSP Sheet with 80~120 GSM zinc coating.
- 60~80 μ powder-coated surface (15~25% gloss) ensures non-shedding surfaces.
- Resistance to abrasion, chemicals, and corrosion with UV protection.
- Non-Progressive design option offers easy removal wherever required.
- Integrated toughened glass view panels and lock-formed doors.
- Return air risers duly reinforced duct with perforated GI/SS grills.
- Walkable/ Non-walkable ceiling panels.

Specifications

- Panel Thickness : 50, 80, 100 mm
- Sheet Thickness : 0.6 mm, 0.8 mm
- Infill : PUF, PIR, Honeycomb, Rockwool
- Height : Up to 6000 mm
- Width : Standard - 1200 mm / Non-Standard
- Floor Track : Raised or C type as per the client's requirement
- Cutouts : Customized factory-made cutouts
- Sealant : Food-grade Silicon



PRE-PAINTED MODULAR PANELS (PPGI)

Key Features

- Fabricated with 0.6 mm thick Pre-painted sheets with 20~25 μ coating on the exposed side (30~40% gloss).
- Smooth, non-shedding, and easy-to-clean surfaces.
- Resistance to abrasion, chemicals, and corrosion with UV protection.
- Quick production and site installation.
- Integrated toughened glass view panels and lock-formed doors.
- Return air risers duly reinforced duct with perforated GI/SS grills.
- Walkable / Non-walkable ceiling panels.



Specifications

- Panel Thickness : 50, 80, 100 mm
- Sheet Thickness : 0.6 mm, 0.8 mm
- Infill : PUF, PIR, Honeycomb, Rockwool
- Height : Up to 7000 mm
- Width : 1200 mm
- Floor Track : C-type
- Cutouts : At Site / Factory



* A Unique Feature : Only AMSL offers in the industry

METAL DOORSETS & ACCESSORIES

Cleanroom Doors, Emergency Doors, Sliding Doors

Key Features

- A large variety of swing type pharmaceutical doors.
- Fully flushed surfaces with wall systems.
- Customized dimensions.

Specifications

- Door Size : 1200 x 600 mm, 1200 x 1200 mm
- Door Thickness : 42 / 44 / 46 mm
- Sheet Thickness : 0.8 mm (Leaf), 1.2 mm (Frame)
- Infill : PUF, PIR, Honeycomb, Rockwool
- Hardware : Renowned Brands like Dorma, Geze
- Inhouse accessories like kick plates and push plate



MODULAR PANELS FOR SEMICONDUCTOR & MICROELECTRONICS CLEANROOMS (Class 1 to Class 100K)

WALL-PARTITION SYSTEMS

- Wall Thicknesses : 50mm, 75mm and 100mm
- Infill Materials : Rockwool, PUF, PIR, Aluminium Honeycomb
- Width : 900, 1182, 1200mm
- Height : Up to 5500mm

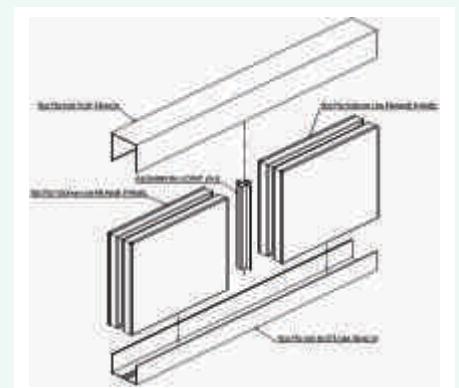

Available Surface Finishes :

RESIN TYPE	APPLICATION METHOD	CONDUCTIVITY	COLOR
PVDF	Roll coat	Non-conductive	RAL Standard
LIFE Antimicrobial	Roll coat	Non-conductive	RAL Standard
Polyester (PE)	Roll coat	Non-conductive	RAL Standard
Stainless Steel	SS-304 / SS-316	Conductive	Matt Finish

CEILING GRID SYSTEMS

Walkable Ceiling Grid System

Our Walkable Ceiling Grid System provides a robust, versatile solution for heavy-duty cleanroom environments, designed to support loads such as live load, utility racking, and FFUs. It ensures faster assembly and efficient installation with solid aluminium alloy cross connectors and one-way locking T-shape bolts, minimizing construction time. Suitable for Cleanroom Class 1 to Class 100K, ensuring a clean environment.

Specifications:

- Ceiling Tee : Height: 70mm, Width: 55mm, Material: Aluminum Alloy
- Panel Type : 30mm thick Aluminum Honeycomb Ceiling Panel
- Facings : 0.5mm PE Roll Coated (non-conductive, grey-white RAL 9010)
- Core : Aluminum Honeycomb (13mm cell size, 0.06mm foil thickness)
- Adhesive : Polyurethane-based adhesive
- Panel Dimensions : 600x1200mm or 1200x1200mm

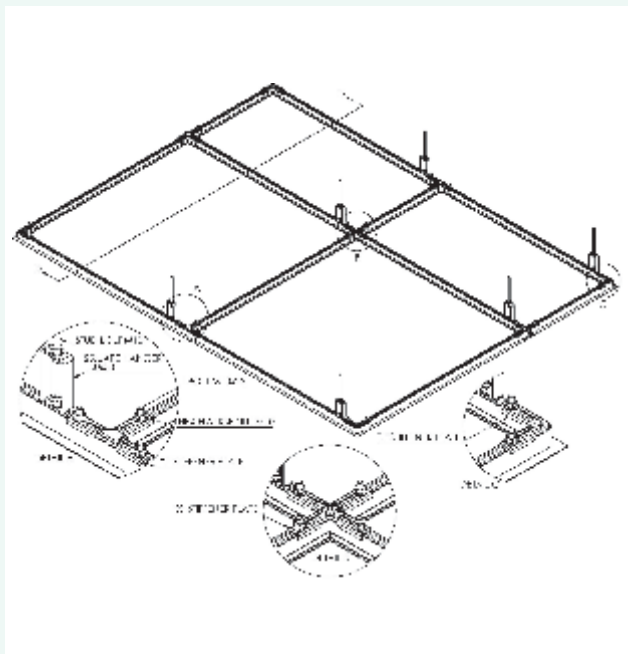

NON-WALKABLE CEILING GRID SYSTEM

Our Non-Walkable Ceiling Grid System offers a comprehensive solution for cleanroom ceilings designed to carry lightweight loads. It ensures quick and easy assembly with steel cross connectors and one-way locking T-shape bolts, resulting in efficient installation and reduced construction time. The system is non-progressive, demountable, and easily relocatable. Suitable for Cleanrooms Class 100 to Class 100K environments.

Specifications:

- Ceiling Tee: Light Duty, Height: 35mm, Width: 38mm, Material: Aluminum Alloy
- Panel Type: Ceiling Blank Panel, Non-combustible
- Material: Cold roll metal sheet, thickness 1.0mm or 1.2mm, powder-coated finish
- Panel Dimensions: 570x1170mm or 1170x1170mm

FLUSHED GRID CEILING SYSTEM

Our Flushed Grid Ceiling System provides a seamless, cleanroom ceiling solution, where ceiling panels are securely clamped between suspended profiles, ensuring a smooth, flush surface. Filter boxes or HEPA modules are integrated directly into the panels, with no visible ceiling tee profiles after installation, resulting in a neat and continuous ceiling surface. Suitable for Cleanrooms: Ideal for environments from Class 100 to Class 100K.

Specifications:

- Ceiling Tee: Height: 90mm, Width: 33mm, Material: Aluminum Alloy
- Panel Type: 50mm Rock Wool Panel, edge sealed with 0.8mm GI sheet framework
- Facing: 0.5mm PE Roll Coated Steel Skin (non-conductive, RAL 9010)
- Core: Rock Wool Slab, Density 100kg/m³
- Adhesive: Polyurethane-based adhesive
- Panel Dimensions: 50mm thickness

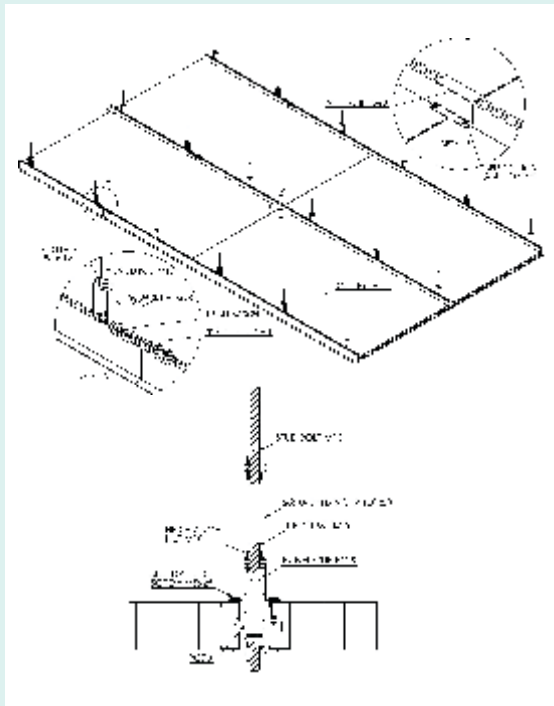
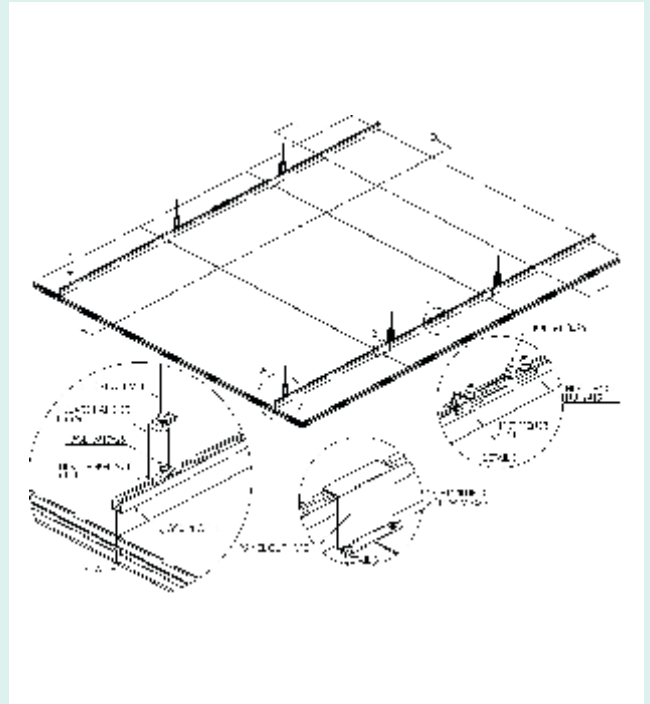

PLENUM CEILING SYSTEM

Our Plenum Ceiling System is designed for cleanroom environments, featuring a structure that connects with plenum ceiling tees and aluminum connectors. Ceiling panels are securely clamped between suspended profiles, and the ceiling tee's bottom part includes a trough for supporting thread rods, enabling a secondary ceiling grid structure for added support and functionality. Suitable for Cleanroom Class 100 to Class 100K environments.

Specifications:

- Ceiling Tee : Height: 90mm, Width: 62mm, Material: Aluminum Alloy
- Panel Type : 50mm Rock Wool Panel, edge sealed with 0.8mm GI sheet framework
- Facing : 0.5mm PE Roll Coated Steel Skin (non-conductive, RAL 9010)
- Core : Rock Wool Slab, Density 100kg/m³
- Adhesive : Polyurethane-based adhesive
- Panel Dimensions : 50mm thickness



Looking Ahead

With global insights and local expertise,
Avanteclad is shaping the future of cleanroom solutions.

Partner with us to innovate, achieve, and excel in controlled environments.

For more information, reach out to our team at contact@avanteclad.in



Avanteclad Modular Solutions LLP

Head Office

BF-77, Opp. Hari Nagar Bus Depot, Janakpuri, New Delhi-110058.
Tel : 011-45508664, 45650702, 45650714. Email : contact@avanteclad.in

Works :

Plot No. 89, Survey/Block No. 1028, Hari Om Industrial Park,
Paldi Kankaj, Ta:Daskroi, Ahmedabad-382425.

Branch Offices

Ahmedabad

A-402, Mondeal Heights,
Besides Novotel Hotel,
S. G. Highway,
Ahmedabad-380015

Mumbai

Office No. 301 & 302, Spaces
912, Commercial Complex,
Near Pleasant Park Signal,
Mira Road (East) Thane-401107

Bengaluru

4C-303, 2nd Floor, 3rd Block,
HRBR Layout, CMR Road,
Opp. Jal Vayu Vihar North Gate,
Kalyan Nagar, Bengaluru-560 043

www.avanteclad.in